

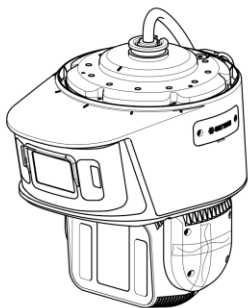

Network Speed Dome

Quick Start Guide

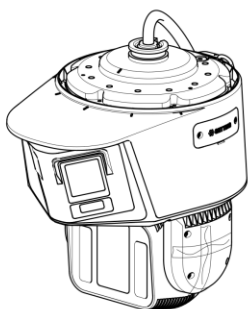

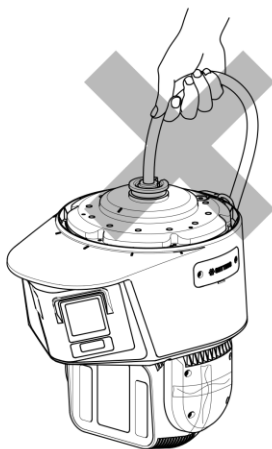
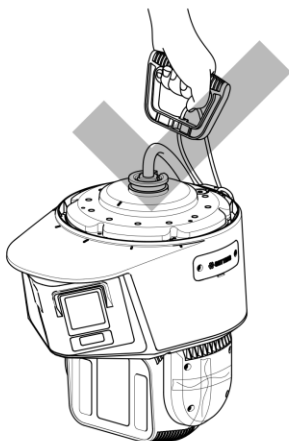

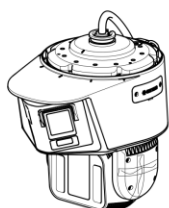

1x

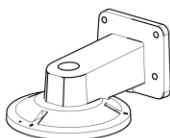

1x



2x*

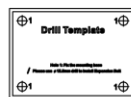

1x



3x



M8×105

1x



1x



HSCSM4×14

1x



1x

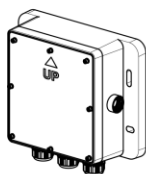

1x



1x



M8×105

1x



3x



3x

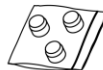

1x

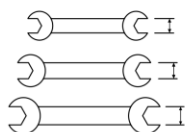

14mm

28mm

32mm



5.0



2.0

Ø12.5mm

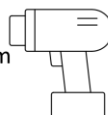

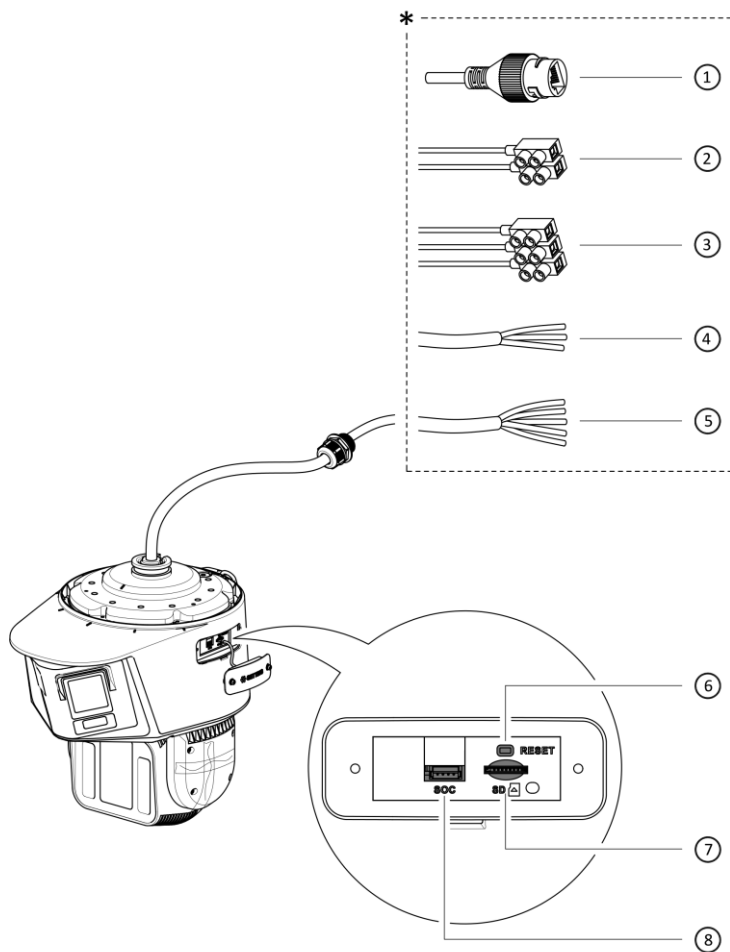

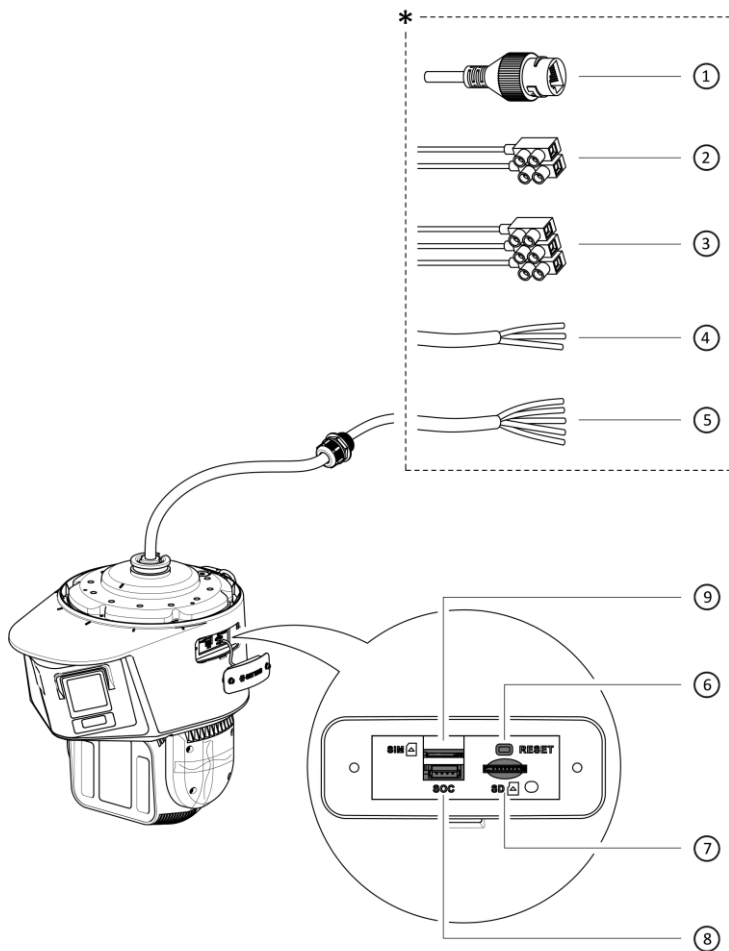

1.1

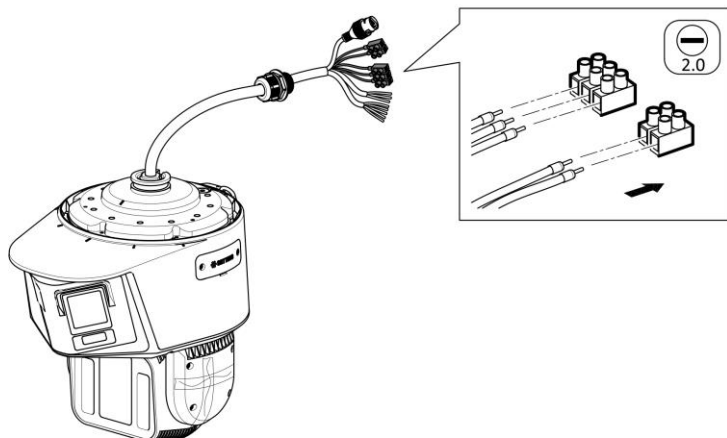

1.2

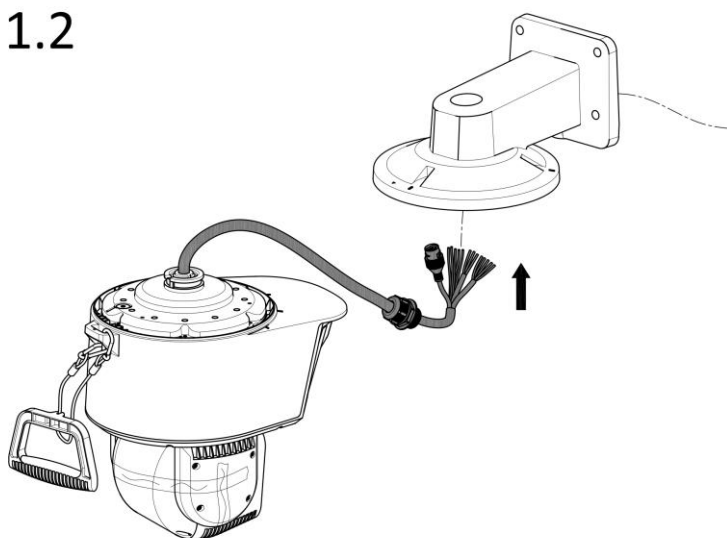

1.3

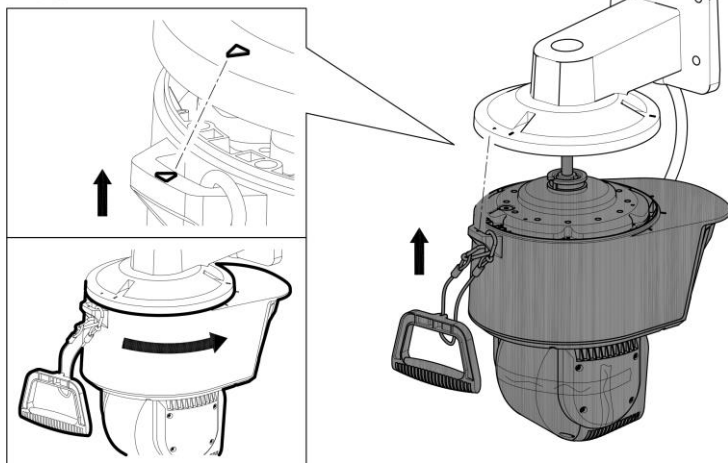

1.4

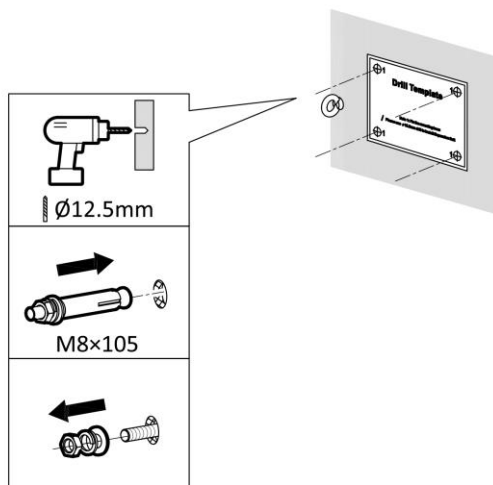

1.5

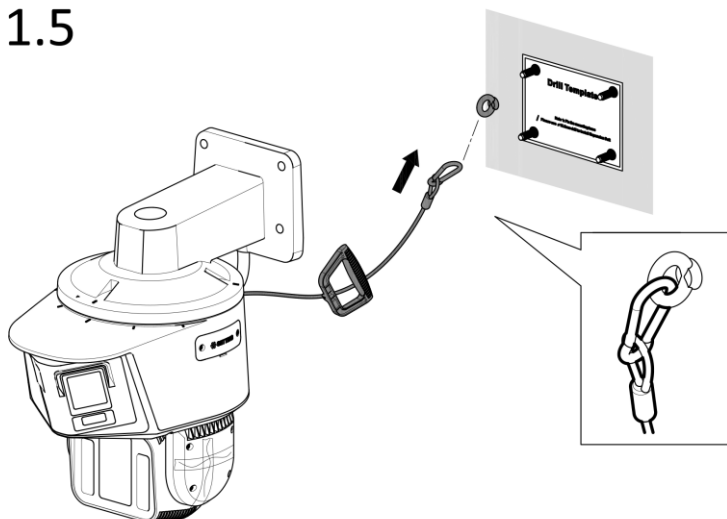

1.6

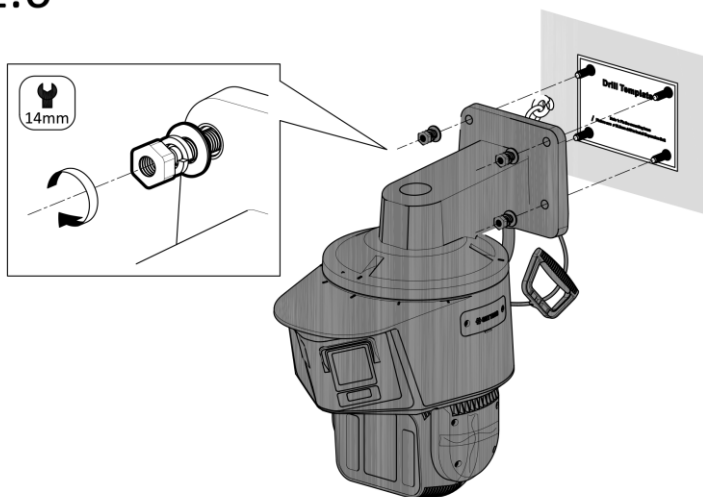

1.7

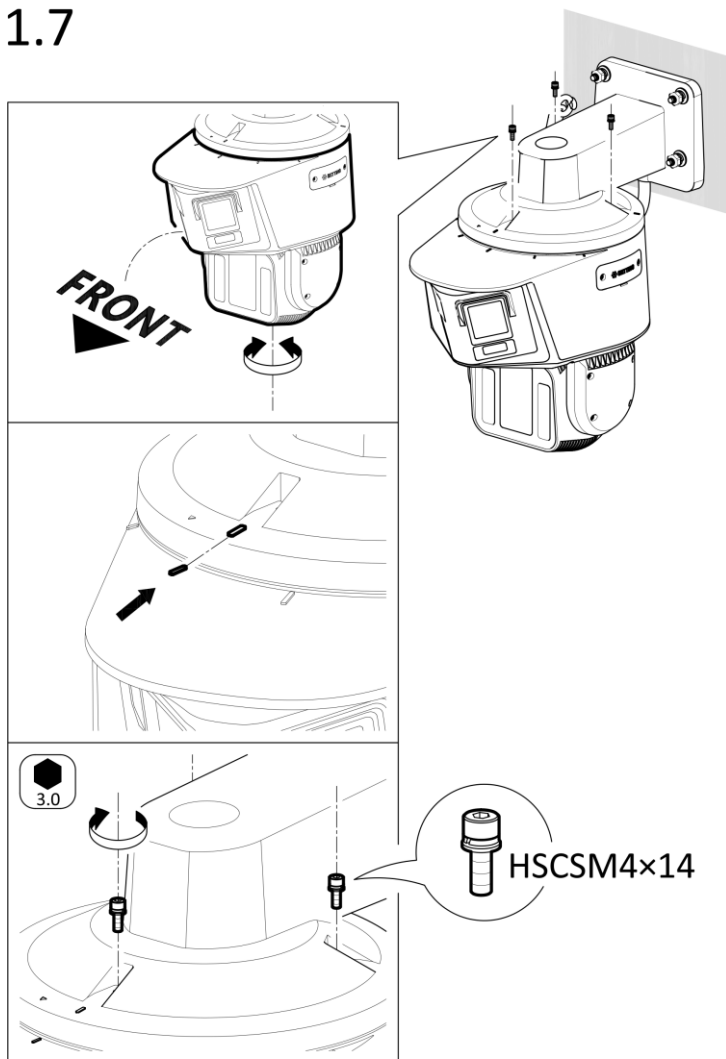

2.1

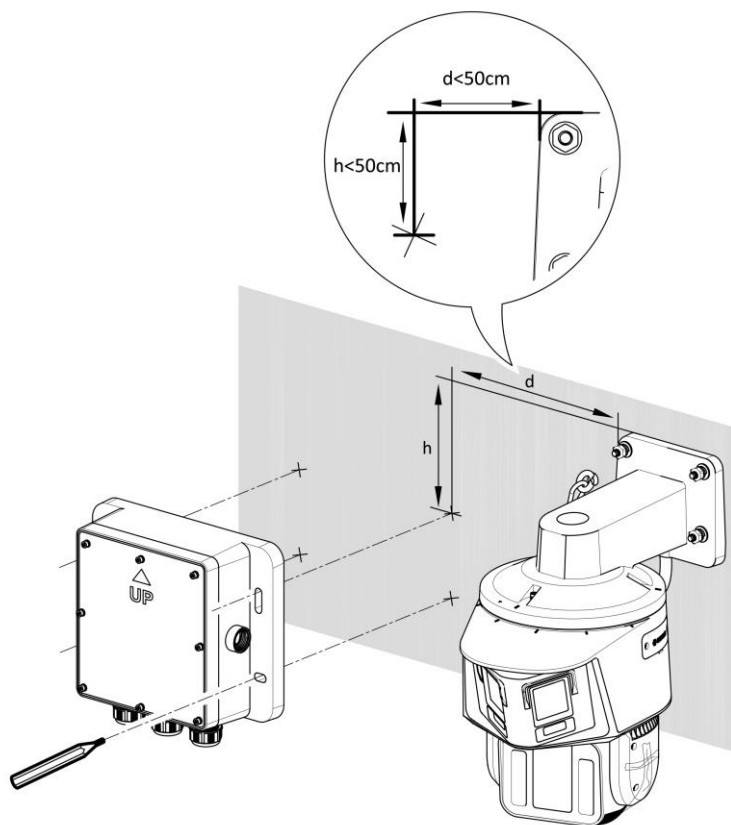

2.2

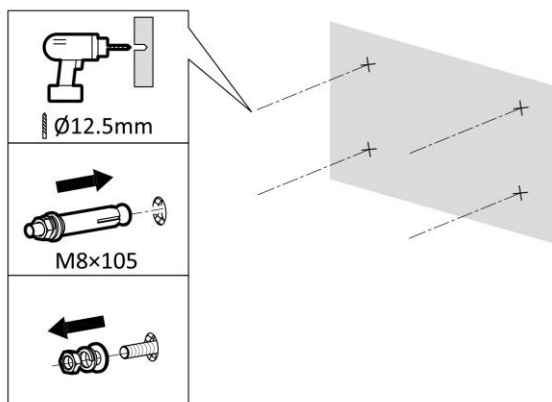

2.3

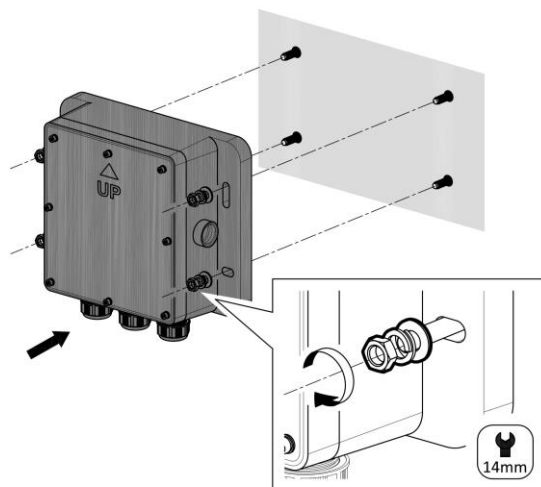

3.1

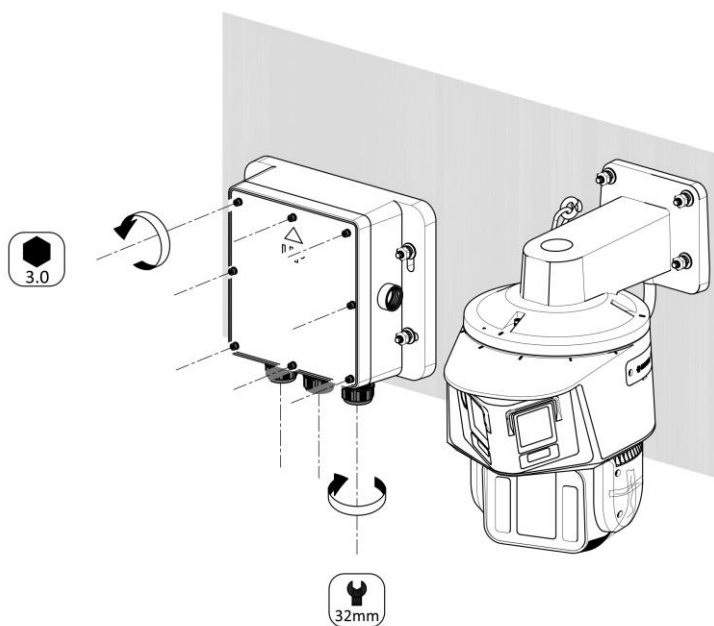

3.2

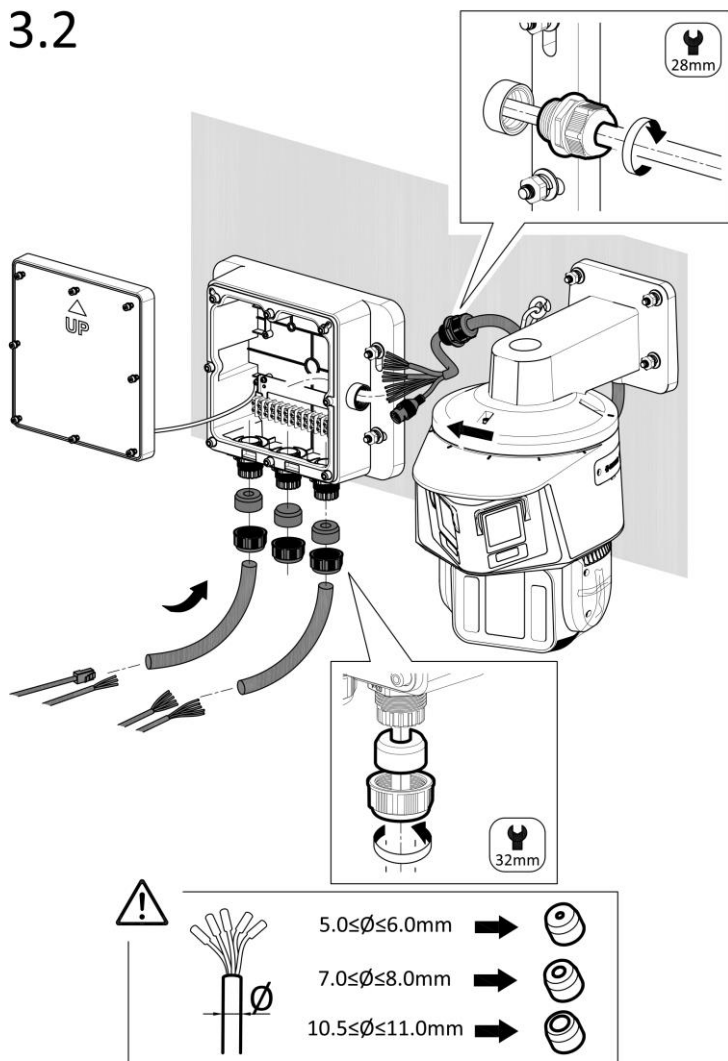

3.3

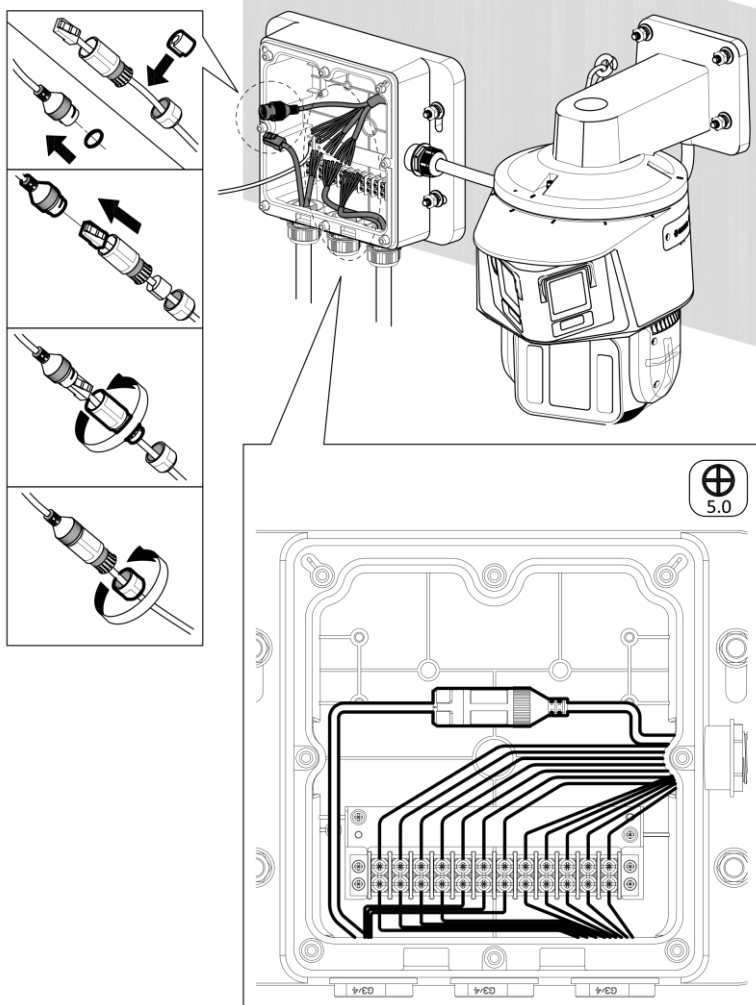

3.4

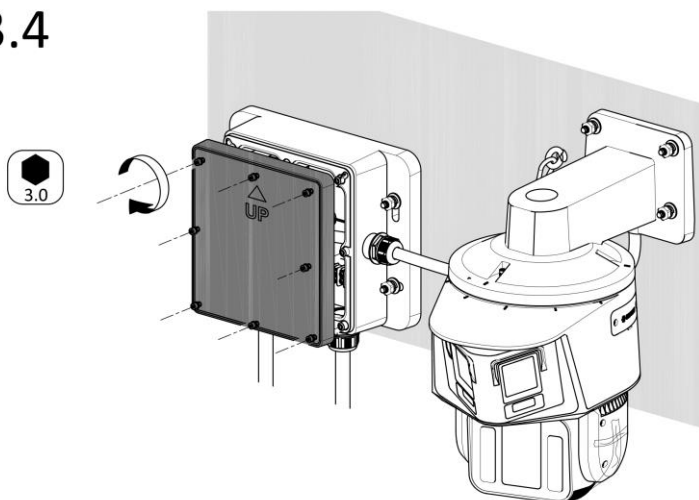

3.5

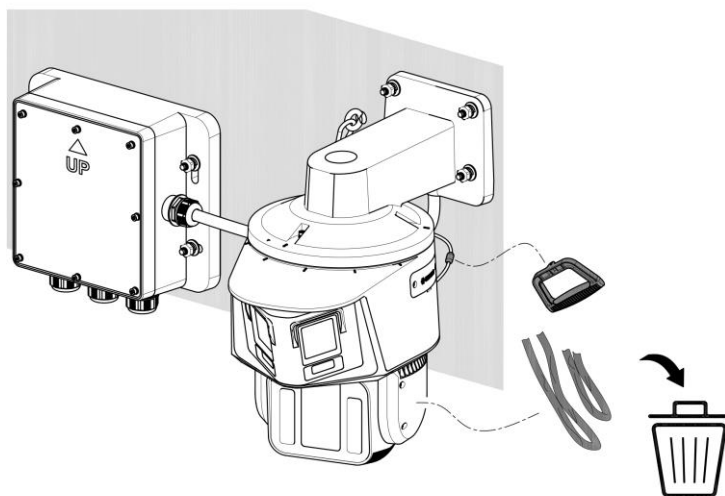

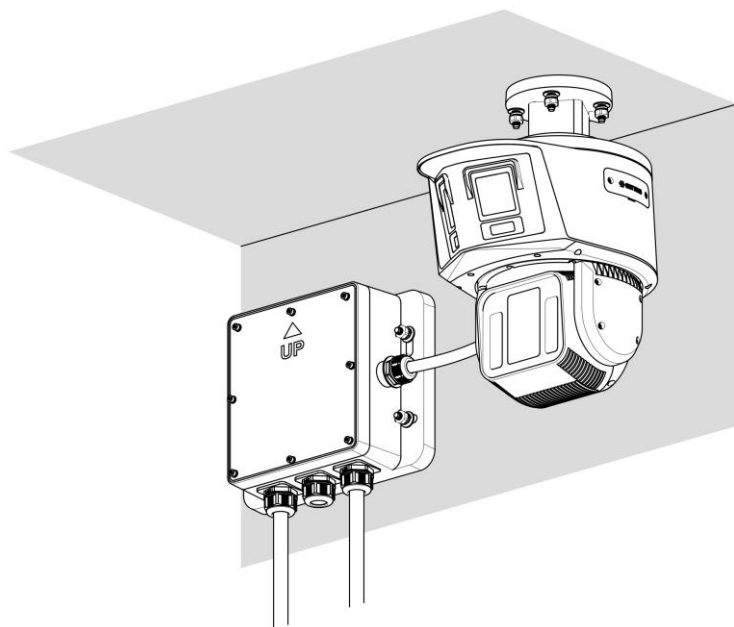

Alarm Output

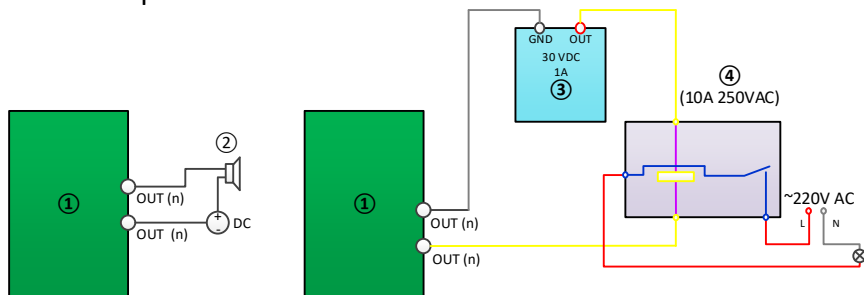

- ① Relay output
- ② DC load
- ③ Power supply
- ④ JQC-3FG relay



Protective Measures for Outdoor Installation



Activate and Access Network Camera



Product appearance is for reference only and may differ from the actual product.

Interface (Page 4 to 5)

- ① Network interface
- ② RS-485 interface
- ③ Power input interface
- ④ Audio interface
- ⑤ Alarm interface
- ⑥ Reset button
- ⑦ MicroSD card
- ⑧ SoC
- ⑨ SIM card slot

Note: The interface varies with the models. Please refer to the product datasheet for details.



See Far, Go Further